

DELTA®-VENT SA KEY MESSAGES FOR APPLICATOR CURRENTLY USING COMPETITOR SELF-ADHESIVE MEMBRANE

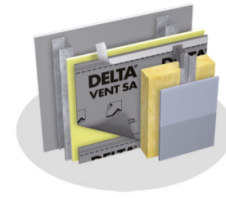

The complete DELTA®-VENT SA system is designed with application in mind to ease the process and reduce time on the job.

- With DELTA®-VENT SA, there is no additional equipment or protection required for application
- Fully adhered from back to edge, DELTA®-VENT SA allows for simple, straightforward application without any fasteners needed
- The DELTA®-VENT SA system is the *only* self-adhering WRB and air barrier with the security of a self-adhesive edge lap – which provides a 100% sealed edge, and makes it easier to apply succeeding rows
- DELTA®-VENT SA is also lightweight, tear-resistant, and tough enough to stand up to the demands of the worksite

DELTA® is the only manufacturer that offers a complete line of application accessories for simple and reliable installation.

- The accessories of the DELTA®-VENT SA system make it easy for applicators to trim and protect every edge for the best fit and tightness, especially around windows
 - Having the complete, manufacturer-designed system takes any complexities, challenges, or inconsistencies out of the process for better application and overall performance
 - The DELTA®-VENT SA system includes DELTA®-FAS CORNER, DELTA®-MULTIBAND, DELTA®-FLEXX BAND, and DELTA®-FLASHING
-

Making the switch from bitumen or sprays can be seamless with the complete support of DELTA® products.

- DELTA® provides very clear and comprehensive installation materials, videos, and technical manuals – the best in the industry – making installation easier, faster, and more reliable
- DELTA®-VENT SA has all the credentials you need, as it exceeds the toughest requirements of the Air Barrier Association of America (ABAA), and meets ICC AC 38 (US code requirements, relevant for International Building Code (IBC) and International Residential Code (IRC)) based on the results of ASTM E2357 - 11 Standard Test Method for Determining Air Leakage of Air Barrier Assemblies